



NDI680

SKID STEER LOADER



NDI 680

skid steer loader

NDI680 is a brand new heavy-duty skid steer loader launched by RIPPA. The whole machine adopts a high-power engine, which increases the flow rate of the whole machine and meets the requirements of more machines. The wheelbase of the whole machine is increased to ensure the stability and safety under high load. It is mainly used in the domestic snow removal market and municipal maintenance and other heavy-duty operating conditions.



NDI 680 Details and benefits

Strong power, energy saving and high efficiency

- The renowned brand engine equipped features strong power, ultra-low emission, and higher fuel efficiency.
- The double-speed motor with maximum speed up to 9km/h is installed to achieve high working efficiency.
- It can respond faster to the needs of emergency working conditions such as rapid snow removing.
- The hydrostatic drive device is applied to realize quick change of appropriate attachments in the operation site.

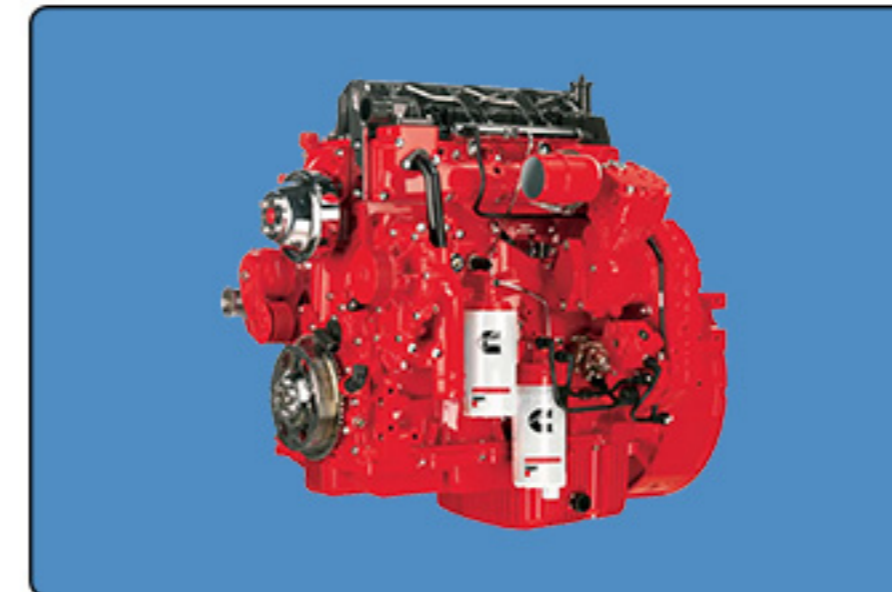

Plateform design for high reliability and firmness

- The serialization design is applied for the frame based on the skid-steer tonnage to realize high structural reliability. All critical structural parts are optimized by finite element analysis to realize reasonable stress distribution.
- The imported high-quality hydraulic parts are applied to realize higher reliability.

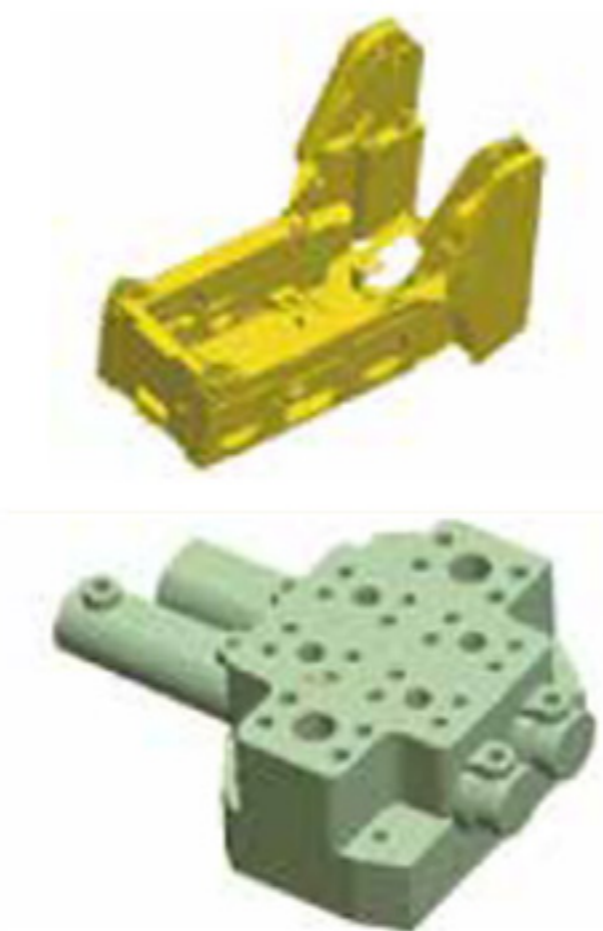

Comfortable operating environment

- RPPA skid steer loader introduces the concept of "functional area" and is designed based on user operating comfort. Luxurious adjustable seats with shock absorption and seat belts, and ergonomically controlled electronic control handles give drivers a different driving experience. The rocker switch of the whole machine is integrated on the left column of the cab. Some commonly used horn and accessory control switches (such as planer cylinder control switches) are integrated on the left and right joysticks (optional).



- The layout of joysticks and the instrument panel is optimized in accordance with ergonomic principles so that all drivers of different body sizes can always maintain the best comfort to make operations easier.
- Centralized switch design greatly improves equipment operation convenience and driver work efficiency.
- The cab is spacious and the seats are adjustable. The cab height is 1900mm, which greatly improves comfort.
- The hydraulic oil cylinder with strengthened design and integrated design can reduce welding seams and prevent the oil cylinder from breaking easily.



More function designs

- The hydraulic oil cylinder with strengthened design and integrated design can reduce welding seams and prevent the oil cylinder from breaking easily.
- Centralized switch design greatly improves equipment operation convenience and driver work efficiency.
- The LCD multi-function display more intuitively displays various parameter information such as machine fuel volume, power, temperature, time, speed, etc.



Maintenance, easy and convenient



[ENGINE]

NDI680 skid steer loader equipped with cummins engine. Powerful performance in a compact design, the excellent performance brought by the extra torque greatly contributes to the improvement of processing performance. At the same time, low fuel consumption, low vibration, low noise, and consideration for the environment have reached a high level.

[REPAIR PARTS]

- All maintenance parts are in the back, and the rear guard can be opened for maintenance and easy replacement.
- The maintenance points are concentrated on the rear of the machine to realize the one-stop repairs/maintenances without uplifing the cab
- The cab can be tilted backward for a large angle to make the repair and maintenance portions more accessible.
- The back cover are easy to open, and all components and pipelines are within easy reach, saving time and effort for maintenance.



One machine with multiple functions

Multi-machine application

- Through market research and test research, the applicability of RIPPA slip loader in the working environment of the whole machine and the machine has done a lot of research. The floating position function is added, so that the boom can float up and down following the uneven ground to meet the needs of more working conditions; Increase the overload oil supplement valve, eliminate the impact of the cylinder to the limit, but also prevent the cylinder suction, improve the service life of the whole machine.
- The international interchangeable quick change coupling enables the rapid and convenient change among tens of attachments, including angle sweeper, now blower, planer, and breaking hammer.



Install different assistive devices

When replacing auxiliary equipment such as hydraulic quick changers, breakers, and wood grabbers, you can easily replace them by pressing the button, which is convenient and quick.

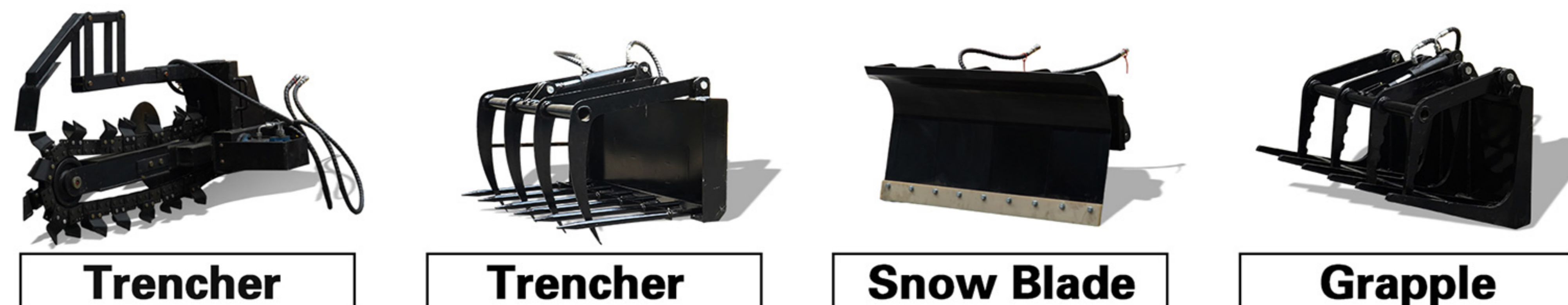

TRACKS (WHEELED OPTIONAL)

Made of thickened and wear-resistant Rubber tracks make the machine more Stable, smooth and safe when walking.



[EXHAUST FAN]

The double-row fan is located above the rear of the machine, which can quickly dissipate heat to the engine and improve work efficiency.



[BUCKET]

Large-capacity bucket, high working efficiency, can shovel up to 1250 kg of cargo.



More performance parameters

Envelope diagram

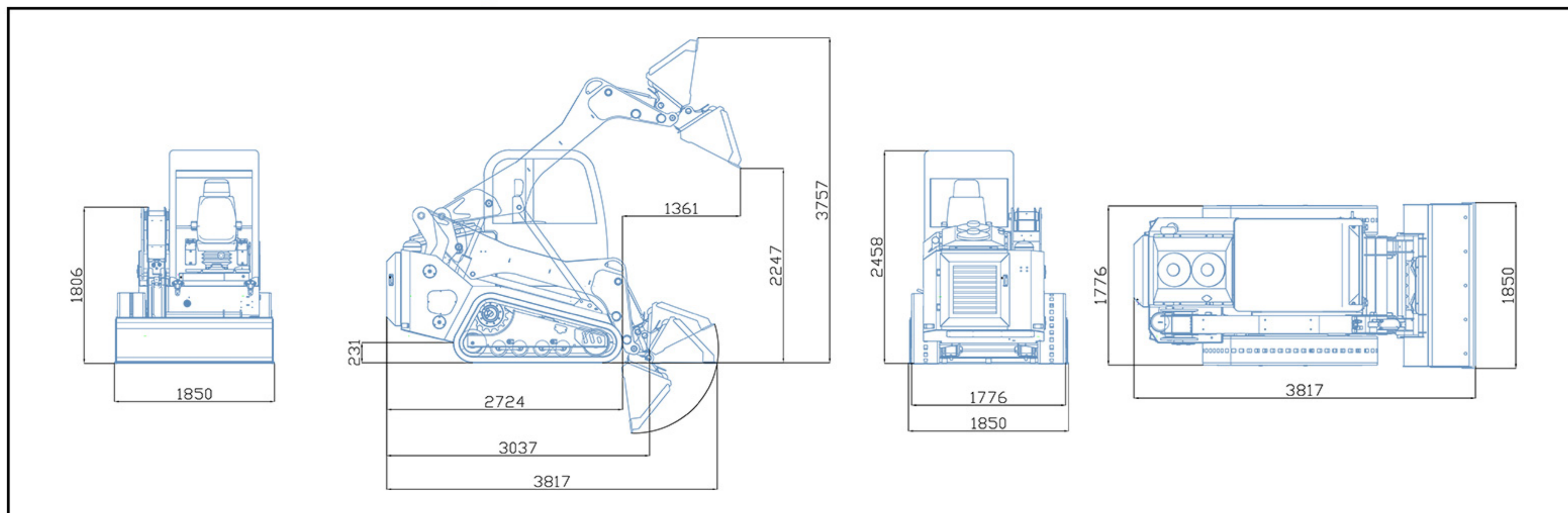

Product parameters

Basic performance parameters	Overall machine weight (kg)	3500
	Rated bucket capacity (m ³)	0.4
	Maximum driving speed (km/h)	9
	Gradeability(%)	25
	Rated charging mass (kg)	1250
	Maximum loading mass (kg)	2100
	Maximum discharge height (mm)	2250
	Discharging distance (mm)	1360
	Bucket lifting time full load (s)	5.6
	Bucket lowering time (s)	4.5
Body data	Overall dimensions (mm)	3820*1800*2460
	Bucket length (mm)	3820
	Length without bucket (mm)	3040
	Maximum lifting height (mm)	3760
	Bucket width (mm)	1800
	Minimum clearance from the ground (mm)	230
	Boom length (mm)	2900
Track tank	Track model (width×pitch×number of sections)	320×84×52
	Hydraulic oil tank (L)	45
Fuel tank (L)	56	

Hydraulic system	traveling pump	model	HP21VG45
		brand	Hengli
		Rated pressure (MPa)	35
		Rated flow rate (L/min)	112.5+112.5
	working pump	model	LX10VO45LADS
		brand	LeZhuo
		Rated pressure (MPa)	25
		Rated flow rate (L/min)	112.5
	working valve	model	LX12SL
		brand	LeZhuo
	Travel motor	Rated pressure (MPa)	22.5
		model	LX21VE45
brand		LeZhuo	
Rated pressure (MPa)		30	
Rated displacement (ml/r)		45*2	
Reducer	model	TFT7T2-32.3A	
	brand	LeZhuo	
	speed ratio	32.3	

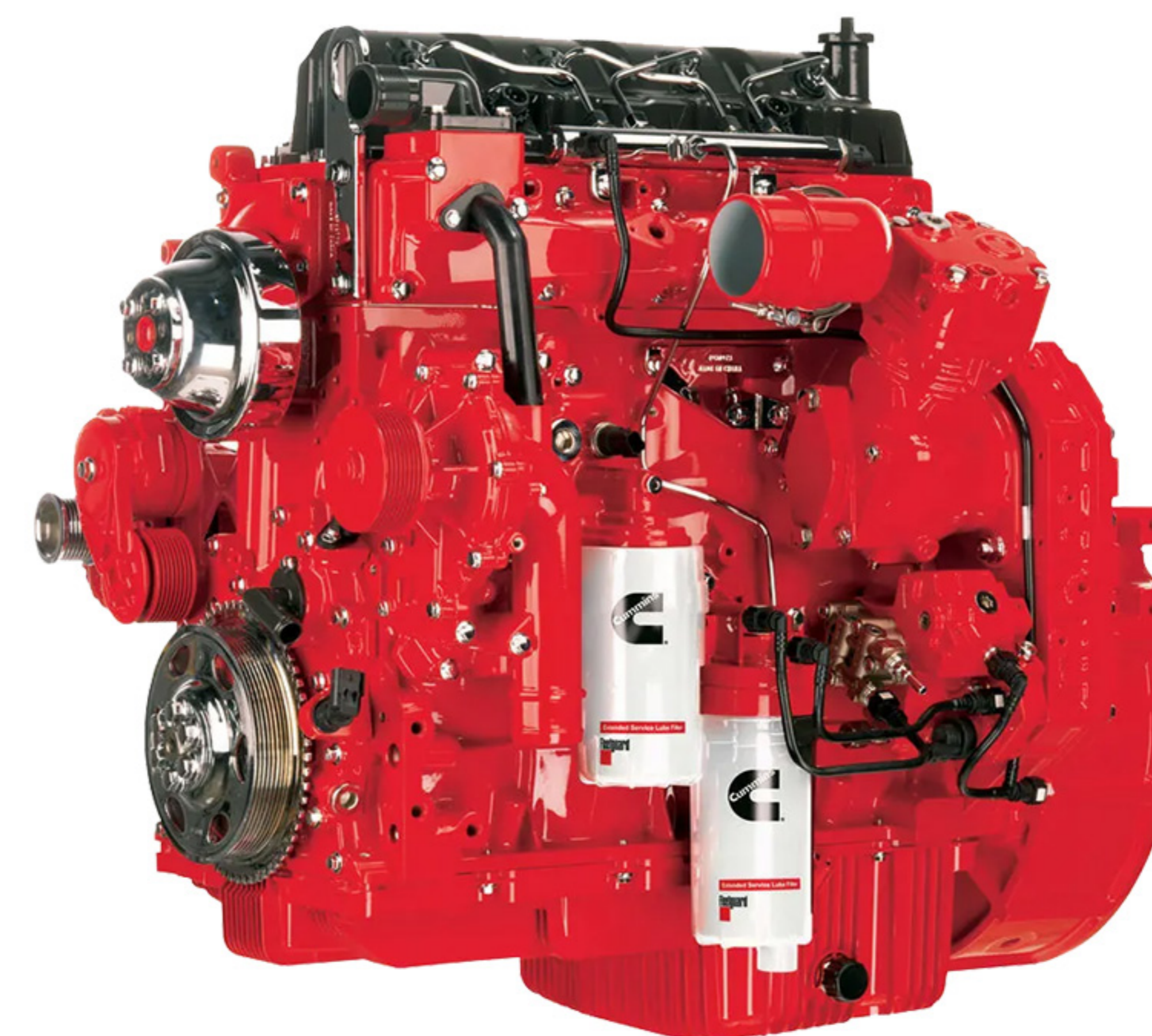

POWERED BY
Cummins
PCEXL02.8AAB

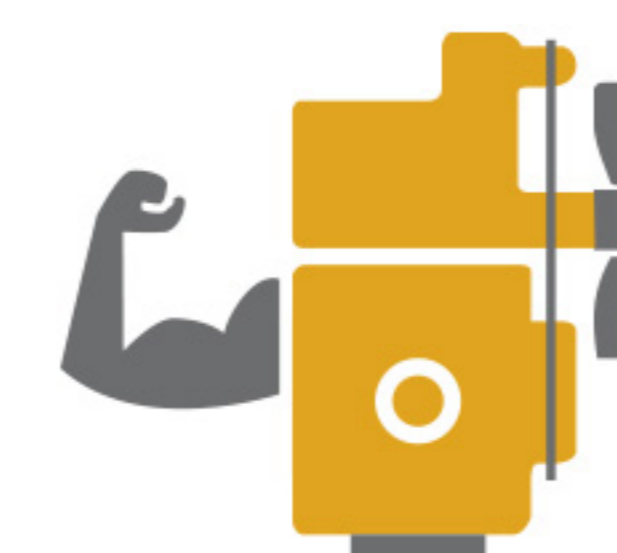

High Performance Engine

High performance engines provide a powerful boost for tough works.



Clean and Low-Noise

Ultra-low noise design, friendly to people and the environment.

Cummins engine	Engine model	PCEXL02.8AAB
	Rated speed (r/min)	2500
	Rated power (kw)	55
	Displacement(L)	2.8
	Number of cylinders	3
	Cooling method	Intercooling + water cooling + hydraulic oil
	Engine oil replacement volume (L)	7.5
	Fuel form	diesel fuel
	Fuel grade	No. 0/-No. 10

WE ARE RIPPA

Shandong Rippa Machinery Group Co., Ltd. is located in the Sixth Industrial Park, Jining high tech Zone, Shandong Province. It is a state-level high-tech enterprise with the right to import and export;

The company's staff are vigorous and enterprising, and constantly create the legend and glory of the school!



Shandong Rippa Machinery Group Co., Ltd.

Add: No.6 Industrial Park, Chongwen Avenue 2166, Gaoxin District, Jining City, Shandong Province

Some specifications are based on engineering measurements and may deviate from actual conditions. Specifications are for comparison purposes only and are subject to change without notice. Specifications of individual RIPPA equipment will vary based on normal variations in design, manufacturing, operating conditions and other factors. Some pictures of RIPPA equipment are not limited to standard packages.



<https://www.rippaexcavator.com>